

PNEUMATIC DIVERT VALVE AV-F

3A Weld / Tri-Clamp / Bevel Seat / IDF / RJT/BSM/ CIP Flat Face / DIN 11851 / SMS 1145 Threaded Male 外牙接口

氣動換向閥 / F 閥

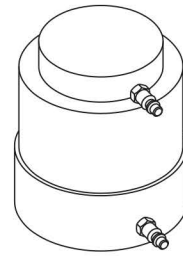
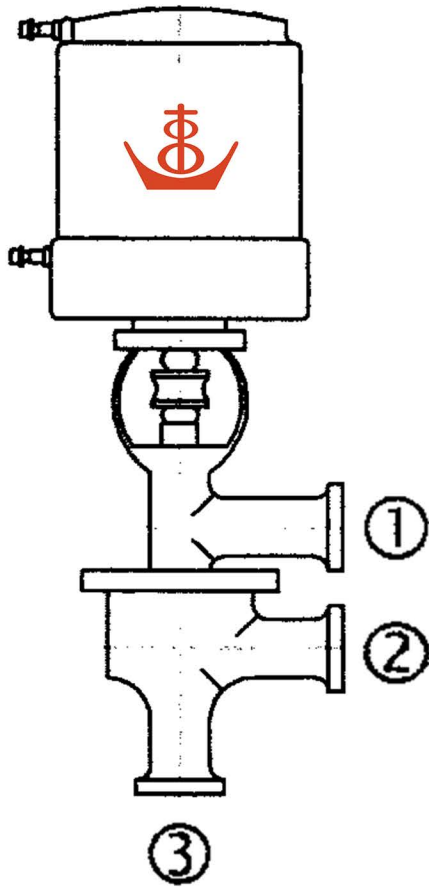

Pneumatic Actuator
氣動筒 SS304



Actuator Clamp
氣動筒管束
13MHMM SS304

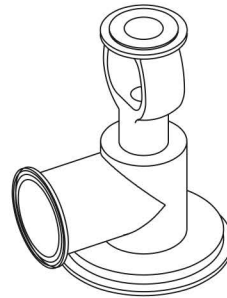

Bonnet, F type
F接帽 SS316

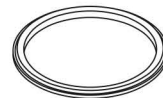

Body Gasket
AVA矽膠体墊 Silicone



Body Clamp
閥体管束
13MHMM SS304

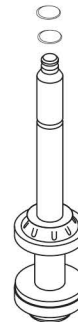

F Stem/Seat Plug Assembly
F塞桿組

F塞桿組 包含 F Stem(F塞桿) SS316 及
以下消耗品:

Silicone Oring *2 (2個 矽膠O環)
PTFE Snap-On Seat *2 (2個 TEFLON塞膠)



Lower Body L, 2 ports
L型雙口体 SS316

N.C. - Normally close port 3, open port 1, 2.
Air to DIVERT (close port 1, open port 2, 3)

N.O. - Normally close port 1, open port 2, 3.
Air to DIVERT (close port 3, open port 1, 2)

常閉: 閉接口 3, 通接口 1, 2.
氣動時, 閉接口 1, 通接口 2, 3.

常開: 閉接口 1, 通接口 2, 3.
氣動時, 閉接口 3, 通接口 1, 2.

N.C. (Normally Close, Air to Open) 常閉

Pneumatic upward movement, Spring return 氣動時塞桿向上運動, 彈簧作用時塞桿返回

N.O. (Normally Open, Air to Close) 常開

Pneumatic downward movement, Spring return 氣動時塞桿向下運動, 彈簧作用時塞桿返回